

# Indoorwpc Wall Panel

**CWB-156**

CWB-120



# 1

## Indoorwpc Wall Panel Show

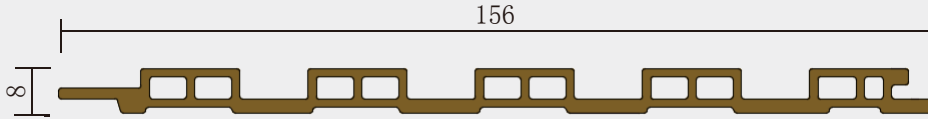

- ▶ Brand: COOWIN GROUP
- ▶ Material: Wood WPC composite
- ▶ Item: CWB-156
- ▶ Size(mm): 156\*8
- ▶ Color: Refer to the color below
- ▶ Surface: Refer to the surface below
- ▶ Standard Length: 2.8m or custom
- ▶ Composition: 45% PVC + 20% calcium carbonate + 28% wood powder + 7% additives
- ▶ Advantage: Moisture-proof, anti-corrosion, anti-insect, long service life.
- ▶ Use scene: Widely used in tooling home improvement, Hotels, guest houses, store decoration, architecture, billboard...



# 2

## Indoorwpc Product Colors



Gray



Yellow



Green



Pink



Orange

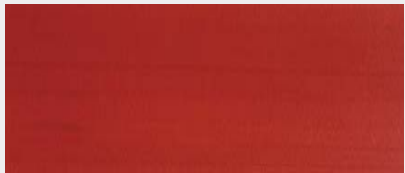

Red



Purple



Blue



Stripe



Black

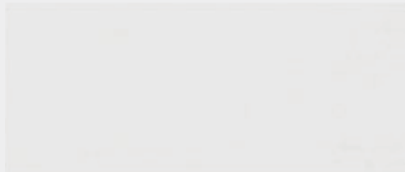

White Oak



Spruce



Ashtree



Boxwood



Pine



Elm Wood



Cedar



Pencil Cedar



Teak



Dark Teak



Rosewood



Merbau



Sandalwood



Walnut



Bronze

# 3

## Indoorwpc Product Surface

COOWIN has a total of up to 95 surfaces available in 4 surface series

This document only shows some of the surface. For more information, please contact COOWIN Product Department.

### Wood Grain Series

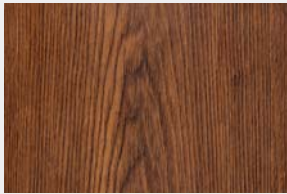

WG01



WG04



WG06



WG08



WG10



WG11



WG12



WG14



WG17



WG19



WG25



WG30



WG31



WG32

### Wall Paper Series



WP04

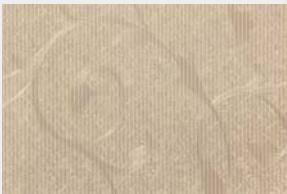

WP05

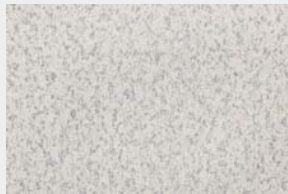

WP06



WP07



WP09



WP11

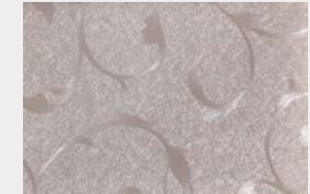

WP12



WP14



WP16



WP19

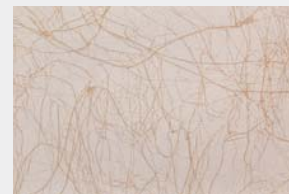

WP20



WP22



WP28



WP38

## Marble Series



MA01



MA02



MA03

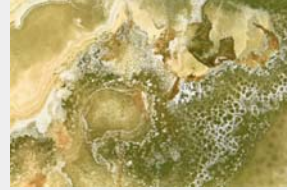

MA04



MA05



MA06



MA07



MA08



MA09

## Pure Color Series



PC01

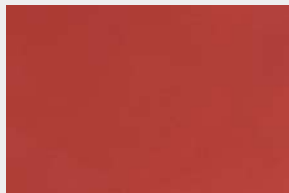

PC02

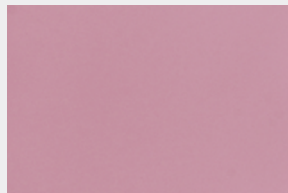

PC03



PC04

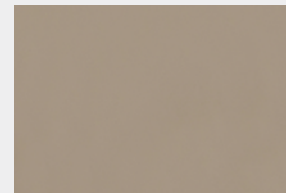

PC05

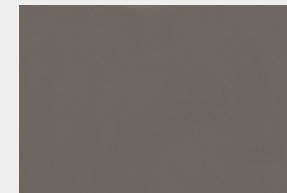

PC06

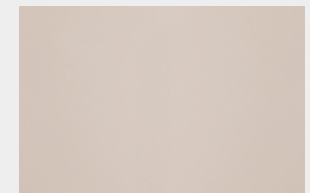

PC07

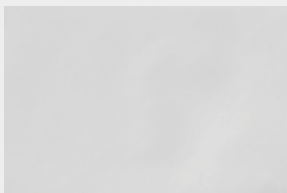

PC08

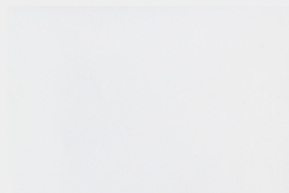

PC09

# 4

## Indoorwpc Product Application Scenario



# 5

## Indoorwpc Materials Production Process

WPC are composite material made of wood fiber/wood flour and thermoplastics(includes PE,PP,PVC etc)

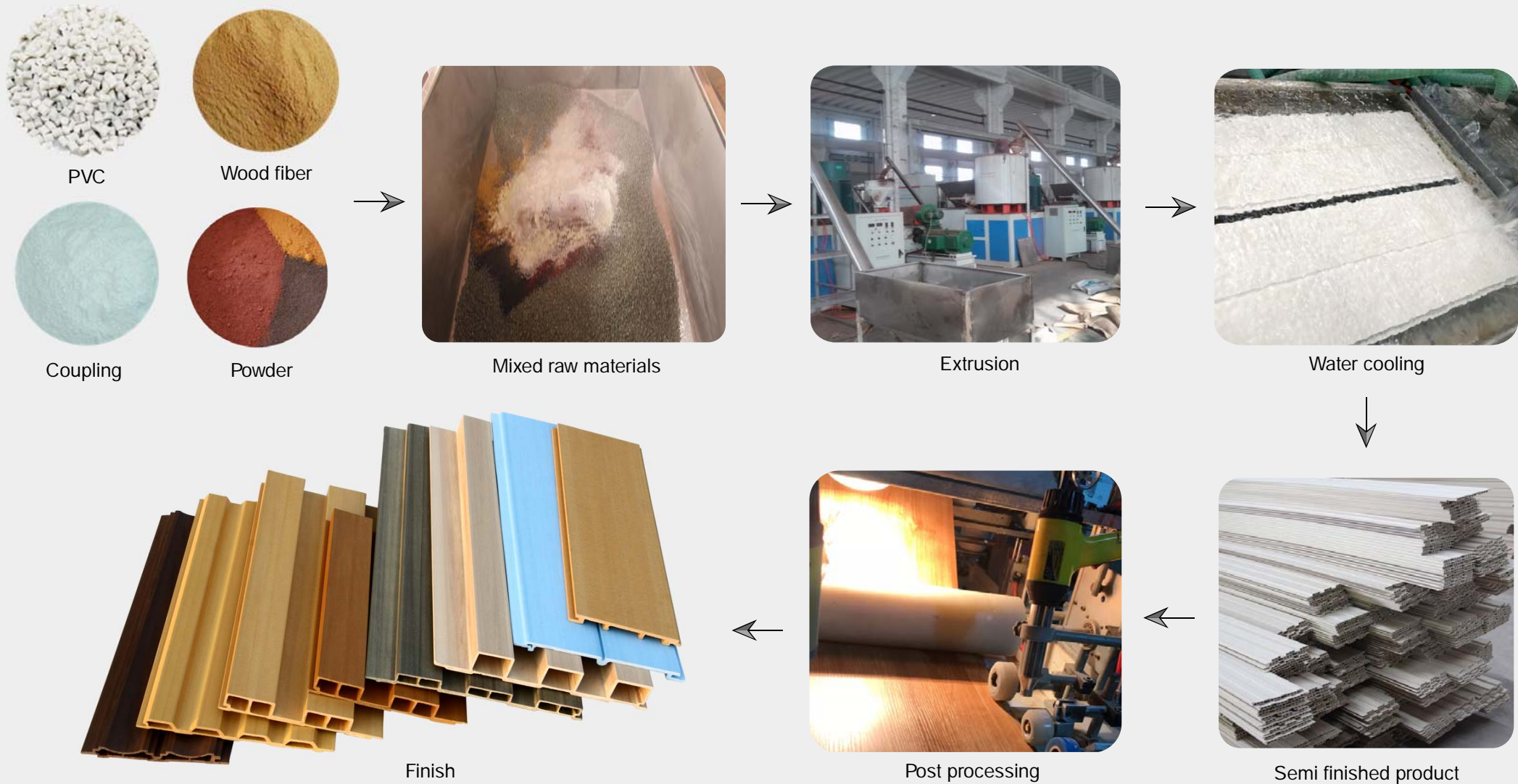

# 6

## COOWIN Indoorwpc Product Workshop

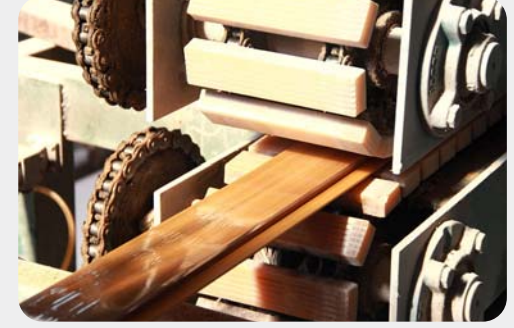



# 7

## Easy installation

**Note: Indoorwpc wall panels are available in a variety of styles, but the installation methods are similar. The wall panels are designed with connecting slots. They can be installed with connectors, or they can be nailed directly to the Joist of the wall with a gas nail gun. The installation efficiency is extremely high.**

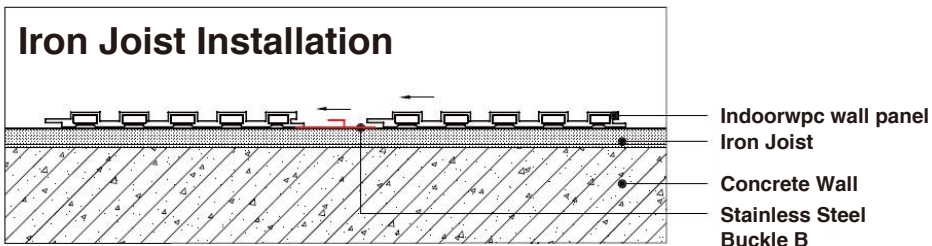

**Stainless Steel Buckle B**

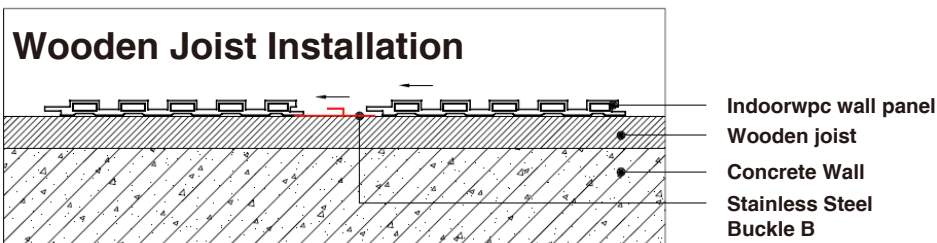
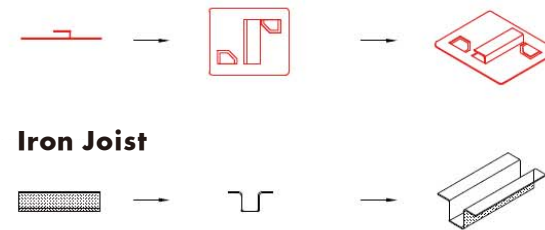

**Note: Use iron joist or wood joist to do the wall leveling job, keep as installation foundation. Fix the first piece of great wall panel on the joist, insert the stainless steel buckle B at wall panel's side, then install the next piece of great wall panel.**

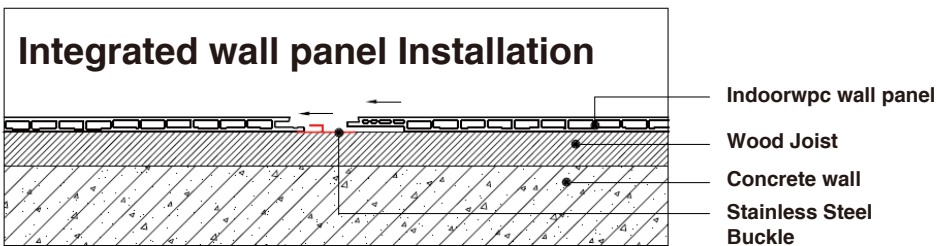

**Stainless Steel Buckle**

# Company Introduction

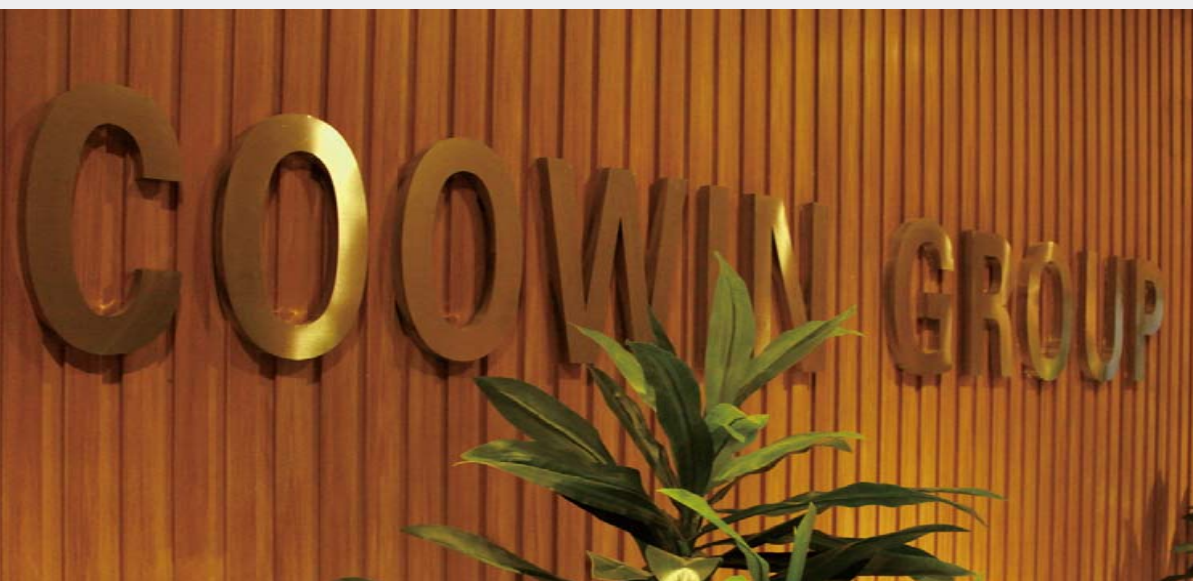

COOWIN GROUP was established in 2000 and the headquarters is located in Qingdao, China. Owing independent high technology manufacturing factory and sales service company. COOWIN is one of the leaders in wood plastic industry. COOWIN has engaged in WPC materials producing, R&D, selling and developing potential market demands for many years. COOWIN's products has been exported to more than 90 countries worldwide and has received broad customers' recognition in both production quality and our service. As China's first batch of wood plastic material manufacturers also R&D leaders, COOWIN has passed the national environmental protection inspection every year since 2010. Meanwhile COOWIN has invested heavily in WPC technology innovation, production equipment updating and environmental pollution control system.

#### Main products:

COOWIN now has 2 series of main products, outdoor and indoor products.

- 1.Outdoor Series: WPC decking, WPC wall siding, outdoor handrail, pergola, bench, flower box and other products used for outdoor place.
2. Indoor Series: Indoorwpc ceiling, Indoorwpc wall siding, Indoorwpc trim, Great Wall board, sound absorber board and other decorative materials for indoor use.
3. In addition, we can also produce customized material based on customer's demands.

#### COOWIN GROUP

Qingdao barefoot construction material Co., Ltd  
No. 220, North Side of the High-Speed Road, Huihu Village, Xinhe Town,  
Pingdu City, Qingdao City, Shandong Province, China

Web: [www.coowingroup.com](http://www.coowingroup.com)  
Email: [coowingroup@coowinwpc.com](mailto:coowingroup@coowinwpc.com)

Tel: +86-532-67731461  
MP: +86 17685736353(WhatsApp)

Fax: +0086-532-67731463  
WeChat: 17685736353